

*o n e   s t e p   a h e a d*

The logo consists of a blue circle with a white border. Inside the circle, the text "CerTest" is written in a white, sans-serif font, and "BIOTEC" is written in a smaller, white, sans-serif font below it. The logo is centered on a dark blue background with a grid of lighter blue dots and a horizontal light streak passing through it.

CerTest  
BIOTEC

CerTest



CerTest Biotec is an independent biotechnology company devoted to the development and manufacturing of IVD products in human, veterinary and Agri-food clinical field. No instrumental diagnostic to identify the causative pathogens of infectious diseases in physicians' offices, labs and hospitals.

CerTest Biotec was established in Zaragoza in 2002 as an innovative and technology-based company. The company's growth is based on the development of new products and the exploration for new market niches and opportunities. The key to understand its success is the way to understand its organization: highly specialised and customer-oriented based.

*one step ahead*

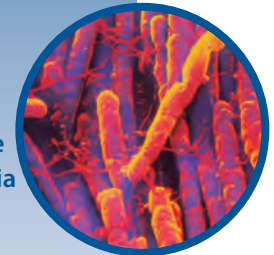

## *mission*

To develop, manufacture and commercialize a wide range of products for the detection of viruses, bacteria and parasites.

## *vision*

Leader in the clinical diagnostics sector (rapid tests), adding new easy-to-use products, technologies and extending our distributor network round the world. Always one step ahead in Research and Development.

## *values*

Customer Oriented • Ethical Conduct • Teamwork • Innovation

## *team*

The multi-skilled team is a dedicated and experience professional group responsible for dealing with all the different company activities in an international environment. Fully commitment to Innovation, Export and high-Technology.

*products*



FECAL ANTIGENS



INFLAMMATORY AND TUMOR MARKERS



RESPIRATORY ANTIGENS



# Fecal Antigens

One-step chromatographic immunoassays for the qualitative detection of antigens in stool samples



## VIRUSES

- Rotavirus
- Adenovirus
- Rotavirus+Adenovirus
- Astrovirus
- Norovirus Gen1+Gen2
- Enterovirus
- Hepatitis A (HAV)

## Fecal Antigens

## BACTERIA

- *H. pylori*
- *C. difficile* (GDH)
- *C. difficile* Toxin A+B
- *E. coli* O157
- Verotoxin 1+2
- *Campylobacter*
- *Salmonella*
- *Salmonella typhi*
- *Salmonella paratyphi*
- *Listeria*
- *Shigella*
- *Yersinia enterocolitica* O:3 + O:9
- *C. perfringens*





# Fecal Antigens

One-step chromatographic immunoassays for the qualitative detection of antigens in stool samples



## PARASITES

- *Crypto*
- *Giardia*
- *Crypto+Giardia*
- *Entamoeba*

## Fecal Antigens

### Test procedure

step 1

Unscrew the cap and use the stick to pick up the sample.

step 2

Close the tube with the diluent and stool sample. Shake the tube in order to assure good sample dispersion.

step 3

Cut the end of the cap and dispense exactly 4 drops into the "A" circular window marked with an arrow.

step 5

Wait for coloured bands to appear.  
Read the result at 10 minutes

step 4

Dispense exactly 4 drops into the "B" circular window marked with an arrow.

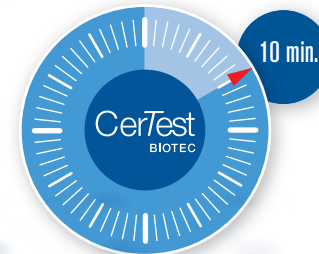

### Interpretation of the results



CerTest  
BIOTEC

# Inflammatory and Tumor markers

One-step chromatographic immunoassays for the qualitative detection of Inflammatory and Tumor markers in stool samples



## MARKERS

- Hemoglobin (FOB)
- FOB+Transferrin
- FOB 50+200
- Transferrin
- Lactoferrin
- Calprotectin
- Calprotectin 50+200
- Calprotectin+Lactoferrin

## Inflammatory and Tumor markers

### Test procedure

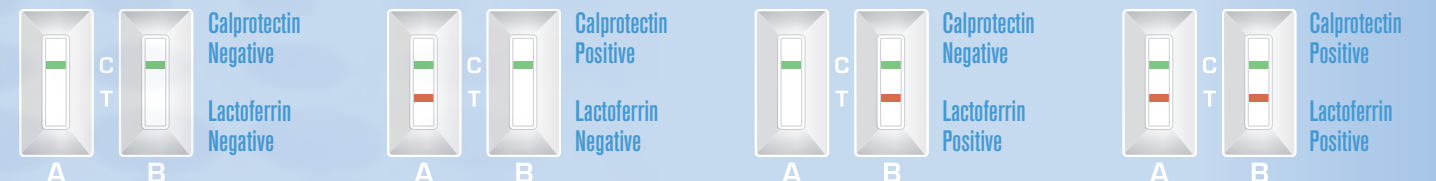
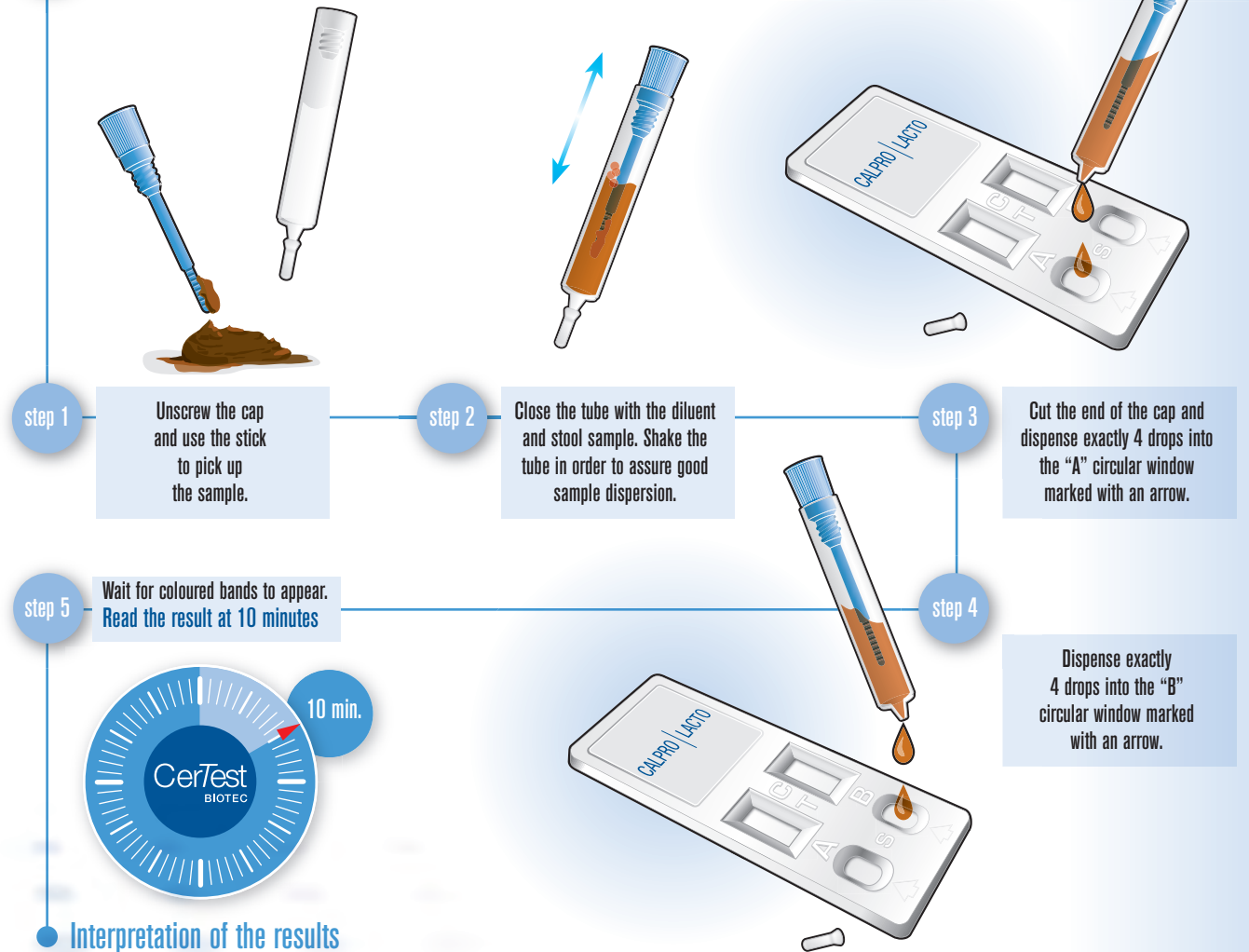



CerTest  
BIOTEC

# Respiratory Antigens

One-step chromatographic immunoassays for the qualitative detection of antigens in nasal samples



RESPIRATORY

- Influenza A+B
- Influenza A
- RSV
- Resp. Adenovirus
- RSV+ Resp. Adenovirus
- Strep. A

## Respiratory Antigens

### Test procedure

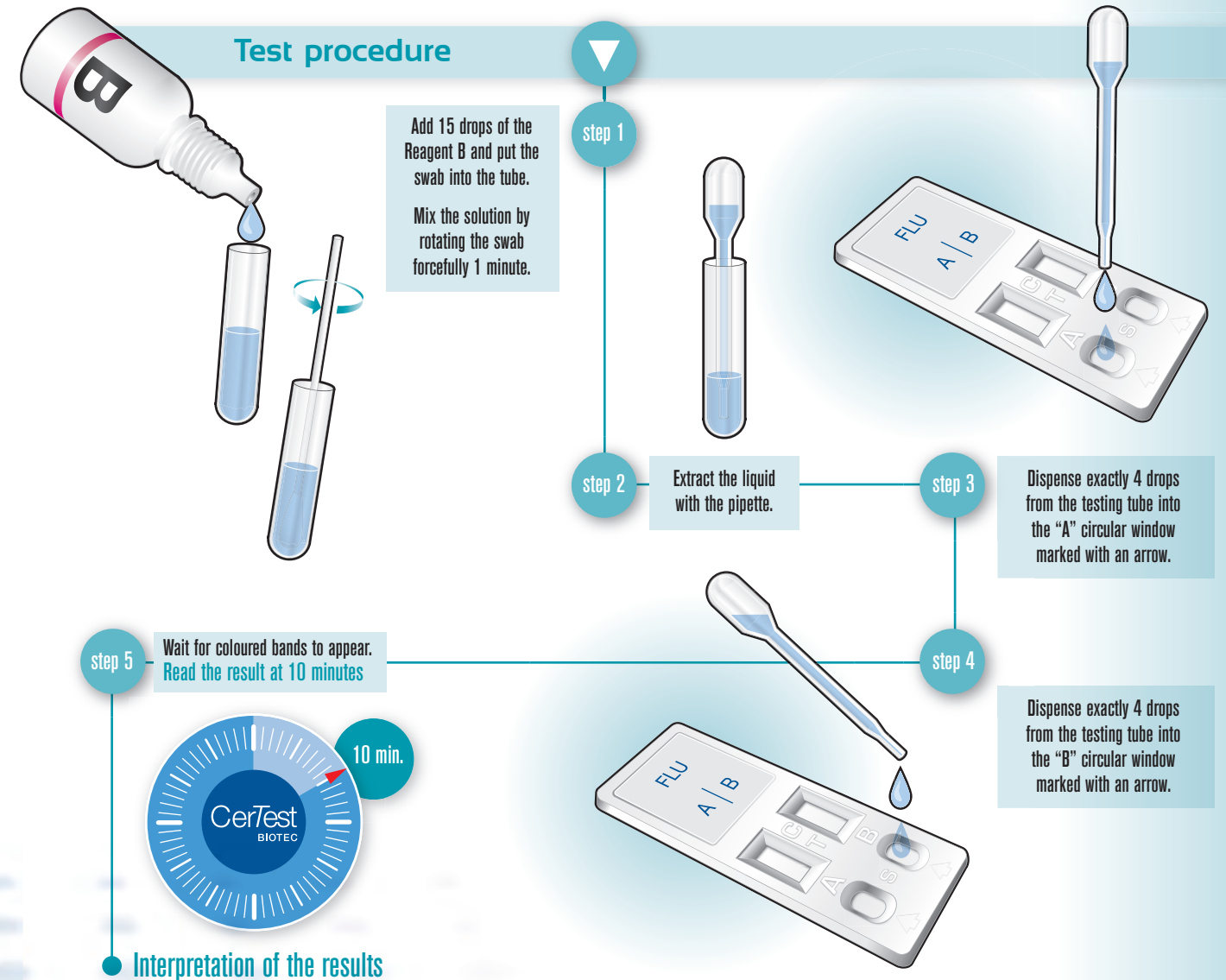

### Interpretation of the results

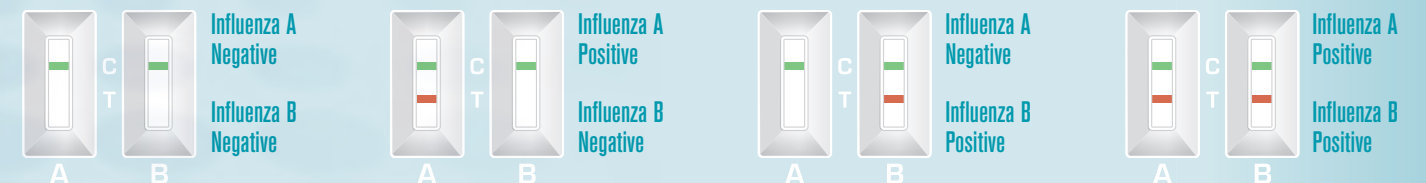



# Combo

Multianalyte testing



- Easy-to-use and interpret in several strip tests
- Intended for one use
- Rapid diagnostic tool, no need of laboratory equipment
- Specimen collection by using solely one collection vial
- Minimize number of test handling
- 2 minutes specimen preparation
- Minimize risk of error in result interpretation

## COMBO CARDS

- Rotavirus + Norovirus Gen1/2
- *H. pylori* + Transferrin
- *C. difficile* GDH + Lactoferrin
- *C. difficile* GDH + *C. perfringens*
- *Salmonella typhi* + paratyphi
- *Shigella dysenteriae* + Shigatoxin







# Combo

Multianalyte testing



## TRIPLE CARDS

- *Rota + Adeno + Astro*
- *C. difficile* GDH + Toxin A + B
- *E. coli* O157 + O111 + O26
- *Crypto + Giardia + Entamoeba*
- *E. coli* O157 + Verotoxin 1 + 2

## QUAD CARDS

- FOB + Transferrin + Calprotectin + Lactoferrin
- *Rota + Adeno + Astro + Noro*
- *C. difficile* GDH + Toxin A + B + Lactoferrin
- *Influenza A + B + RSV + Resp. Adenovirus*







*one step ahead*

Certest Biotec, S.L.

Pol. Industrial Río Gállego II • Calle J, Nº1

Tel.: +34 976 520 354

50840 San Mateo de Gállego • Zaragoza

Spain

[www.certest.es](http://www.certest.es)

